

LOCAL COMMUNITY INFORMATION



MICHAEL BIBI



FRIDAY 05 JULY
THE WOLFE TONES

SATURDAY 06 JULY
MICHAEL BIBI

SUNDAY 07 JULY
HOZIER

FRI 12 - SUN 14 JULY
WIRELESS FESTIVAL

OUR RESIDENT'S HOTLINE TEAM ARE AVAILABLE DURING ALL THE ABOVE LIVE EVENTS ON:

020 8080 1459

WE HAVE 3 HOTLINE HANDSETS, IF ONE IS ENGAGED IT WILL REDIRECT TO THE OTHERS. YOU SHOULD ALWAYS BE ABLE TO GET THROUGH TO TALK TO THE TEAM. ALTERNATIVELY, PLEASE EMAIL:

finsburypark.residents@festivalrepublic.com

WE WILL DO OUR BEST TO RESPOND TO EMAILS WITHIN 48 HOURS IN THE LEAD UP TO THE EVENT AND THEN DAILY ON EVENT DAYS. IT IS MUCH QUICKER TO PHONE DURING EVENT DAYS THAN IT IS TO EMAIL

PHONE LINE OPERATIONAL AS BELOW:

BUILD: 08:00 – 20:00 FROM WEDNESDAY 26 JUNE TO THURSDAY 4 JULY & MONDAY 8 TO THURSDAY 11 JULY
LIVE SHOW DAYS: BETWEEN 08:00 – 02:00 (SEE BELOW TABLE FOR DATES)
BREAK: 08:00 – 20:00 FROM MONDAY 15 JULY TO FRIDAY 19 JULY

LIVE SHOW DAYS	EVENT OPENS	MUSIC ENDS	HEADLINER	CAPACITY
Fri 05 July	13:30	22:30	The Wolfe Tones	45,000
Sat 06 July	11:00	22:30	Michael Bibi	45,000
Sun 07 July	11:00	21:30	Hozier	45,000
Fri 12 July	13:30	22:30	Wireless	45,000
Sat 13 July	11:00	22:30	Wireless	45,000
Sun 14 July	11:00	21:30	Wireless	45,000

PLEASE NOTE: OPENING TIMES SUBJECT TO CHANGE

WE CANNOT RESPOND TO AN ISSUE IF WE DON'T KNOW ABOUT IT – WE ASK THAT YOU PLEASE CONTACT OUR HOTLINE BEFORE CALLING YOUR LOCAL COUNCIL. HOWEVER, WE RESPECT YOUR RIGHT TO CONTACT YOUR LOCAL COUNCIL AT ANY TIME.

This info guide has been prepared to give you advance notice of our July events. It includes lots of useful information e.g. temporary traffic restrictions and routes in your area, access routes in and around Finsbury Park, operating times, and ways to contact the event/partner agencies. Sometimes things change after we send this letter to print so we strongly advise you to check our website for the most up-to-date information at:

www.festivalrepublic.com/finsbury-park-residents-information/

Festival Republic

LIVE NATION

Festival Republic

LIVE NATION

Parking Restrictions - What roads will be affected and when?

HARINGEY PARKING INFO AND RESTRICTIONS

On all event days the following parking controls will be in operation within Haringey.

- The Event Day controls in Finsbury Park CPZ, Finsbury Park B & C CPZs** will be operational until 20:30 on the dates listed above.
- The existing Green Lanes A CPZ times will be extended** on the following dates and roads:
 - Friday 05 and Friday 12 July – 18:30 and 20:30
 - Saturday 06 and Sunday 13 July – 08:30 and 20:30
 - Saturday 07 and Sunday 14 July – 08:30 and 20:30

Wightman Road, Umfreville Road, Warwick Gardens, Railway Approach, Woollastone Road, Roseberry Gardens, Warham Road, Atterbury Road, Devon Gardens, Pemberton Road, Cyprus Close, Rutland Gardens, Mattison Road, Salisbury Road, Essex Gardens, Duckett Road, Kimberley Gardens, Grafton Gardens, Cavendish Road, Cleveland Gardens, Stanhope Gardens, Burgoyne Road, Chesterfield Gardens, Portland Gardens, Doncaster Gardens & Sussex Gardens.

- The existing Green Lanes B CPZ times will be extended** on the following dates and roads:
 - Friday 05 and Friday 12 July – 18:30 and 20:30
 - Saturday 06 and Sunday 13 July – 08:30 and 20:30
 - Saturday 07 and Sunday 14 July – 08:30 and 20:30

Alroy Road, Conningsby Road, Endymion Road, Lothair Road North, Lothair Road South Tancred Road and Venetia Road, N4

- Osbourne Road parking bays will be suspended** for the duration of the event days to facilitate Private Hire, Uber and Bolt drop off and pick-ups. This will end at midnight.

This means on the days and times listed above, vehicles must not park in any residents/business parking bay on these roads unless they display a valid Green Lanes CPZ (GLA & GLB) permit or visitors' permit. Existing parking restrictions apply.

HACKNEY PARKING INFO AND RESTRICTIONS

To ensure that residents in the Finsbury Park area are not impacted by the increase in visitors driving to the events, Hackney Council will extend the hours of control in Parking Zones G and G2 during the six show days to 23:00.

During that time, vehicles will need to display a valid permit to park in any of the resident permit, permit holder only, and business permit bays in the areas between the hours set out below:

Zone G

Friday 05 & Friday 12 July between 18:30 – 23:00
Saturday 06 & Saturday 13 July between 11:00 – 23:00
Sunday 07 & Sunday 14 July between 11:00 – 23:00

Zone G2

Friday 05 June & Friday 12 July between 18:30 – 23:00
Saturday 06 & Saturday 13 July between 18:30 – 23:00
Sunday 07 & Sunday 14 July between 11:00 – 23:00

Parking in pay and display and shared use parking bays will retain the same hours of operation.

There will be resident only soft closures at Somerfield Road, Gloucester Drive, Portland Rise and Queens Drive to prevent any non-local vehicles parking in resident spaces.

Warning signs and posters will be displayed in the areas affected to advise drivers of the changes to the hours of operation. Please contact Hackney Parking Services on 020 8356 8877 or via email at consultation.parking@hackney.gov.uk if you have any queries.

ISLINGTON PARKING INFO AND RESTRICTIONS - Soft Closure to prevent anti-social behavior in resident parking in Islington

Although we strongly encourage everybody who attends the concerts to use public transport, Islington Council is putting in place further controls to ensure residents are not disrupted by additional traffic.

There will be additional enforcement patrols as the controlled parking hours will reflect arrival and departure times of festival goers. There will be no cost to those who already have a residents parking permit. There will be road closures so

DEAR RESIDENT & LOCAL BUSINESS

I am writing to you from Festival Republic to confirm our 2024 plans and events in Finsbury Park. We will have two weekends of live music. A weekend of concerts from Friday 05 July – Sunday 07 July and Wireless Festival from Friday 12 – Sunday 14 July. We are really looking forward to working in the community again.

In this letter, you will find details of plans developed with Haringey (leading managing authority for Finsbury Park and lead council for this event), Hackney and Islington Councils, TFL, Metropolitan Police, British Transport Police, GTR, London Ambulance Service and other statutory bodies. We meet monthly to discuss the smooth running of the events. We are committed to providing you with as much information relating to the events as possible. However, we can only fit a certain amount of text into this letter. Please visit our dedicated residents website for the most up to date information.

Festival Republic aims to mitigate any potential issues faced by residents over the events. To do so, we have been working closely with the local community all year round.

RESIDENTS INFORMATION LINE, COMMUNITY RESPONSE & CONTACT DETAILS

Should you have any comments or concerns during the events, we operate a hotline for local residents so you can speak directly with us. Please do not hesitate to contact us straight away on the number on the front page of the letter. From there we can offer any relevant answers or assistance.

We ask that you please be polite with our Hotline Operators. They are there to help and will do their very best to assist you by taking details of your enquiry / complaint and contacting the appropriate team to action a response. You will be given a unique reference number which Festival Republic will use to track your reason for contact, please make sure to request this and keep your own record too.

Our Community Response Team will include event management, cleaning and security staff who are able to respond to any issues we see, or which are identified by the local community. We have a significant number of security guards working in the local streets to address any issues that may arise within Hackney, Islington and Haringey.

NOISE

Sound checks and rehearsals will take place the day before, and the morning of, each event. The times of sound checks and rehearsals are agreed in advance with Haringey Council. They will not exceed a 90-minute duration within a pre agreed 3-hour window. Low level recorded music will be played once gates open until the first act comes on stage.

In 2022, we carried out an independent vibrations study during live event show days. We will be bringing this back over the 2024 events. More information about this will be displayed on our website in due course.

Please note: there will be two local community music events taking place on Tuesday 09 and Wednesday 10 July. These events are run by Haringey Council and give opportunities to local schools and artists within Haringey, Hackney and Islington. Please do join us for two afternoons of fantastic local talent! Internal roads and paths within the park will be temporarily unavailable on both these days. Visit www.haringey.gov.uk/finsburyparkevents for tickets and further details.

PYROTECHNICS

Pyrotechnic displays will happen throughout the events. The timings of these displays will be published on the resident website once confirmed. Please check our website for more information at www.festivalrepublic.com/finsbury-park-residents-information/.

TRAFFIC PLANS ON EVENT DAYS

Please allow extra time for your journey during peak times. Do visit our website for further details of the traffic routes in the wider area around Finsbury Park that may affect your normal road journeys over the days of the event. Please plan your journeys and follow the instructions posted plus any additional signage as well. Please do pre-alert any of your visitors of this information too.

We hope the advance notice of the traffic restrictions and event traffic routes will enable you to plan your journeys but also to notify visiting family, friends and customers. Please note - it may be necessary for additional restrictions/changes to plans after this letter has been sent to you. Please check the websites for updates.

We recommend carrying this letter if driving in the local area as stewards will be briefed to allow access if this letter is present. Other proof of address will be accepted too for you or your visitors. Festival Republic's intention with these closures is to prevent unnecessary traffic and footfall through your area.

that the venue can be emptied quickly, efficiently and above all, safely. We do not plan to divert traffic along residential roads and all signed diversions will be on A-roads. We aim to keep the duration of any closures as short as possible. Festival Republic is working with all three councils and colleagues in TFL and emergency services to minimise any disruption caused by these events.

There will be a soft road closure at the following:

Junctions of St Thomas's Road, Prah Road, Ambler Road, Monsell Road, and then along Gillespie Road at the junctions of Plimsoll Road, Ambler Road, St Thomas Road.

At each point of the closure, there will be event marshals to allow:

- Any resident permit holder through or resident with a copy of this resident letter
- Any resident with proof of residency in the zone (as some may not be permit holders)
- Any vehicle which claims to be visiting a resident in the zone, we request that local residents ask for their visitors to supply the name and address of the resident they are visiting.

The event marshal will also link in with the dedicated event response team for this location.

Please be aware that during the egress, Islington residents living in the Highbury LTN will need to follow a diversion route in order to drive in or out of this zone whilst Rock Street is closed. A copy of this route will be published for your information on the Wireless Festival residents page as detailed above.

TIMINGS

The timings for the parking restrictions in this location are as follows:

Mon - Sat 08:30 – 18:30,

It is anticipated that operatives and barriers will be in place from 13:00 until 00:00 on Friday, from 11:00 until 00:00 on Saturday and from 11:00 until 23:00 on Sundays.

ROAD CLOSURES – AS ATTENDEES LEAVE FINSBURY PARK FOR THEIR JOURNEYS HOME

Road closures are there to ensure the safe egress of the public leaving the park.

Please try and avoid the roads during these times to prevent a delay in your journey to and from home.

Seven Sisters Road (between Fonthill Road and Green Lanes)

- Closed for 1.5 hours at the below times. Please note these are approximate timings.

Stroud Green Road (between Seven Sisters Road and Tollington Park / Upper Tollington Park)

- Closed for 3 hours at the below timings. As soon as the bulk of the crowd has left Finsbury Park Station, Festival Republic will work with the relevant authorities to ensure the road is open and the buses are back on regular routes when safe to do so.

ROAD CLOSED	STROUD GREEN ROAD CLOSURE TIMINGS	SEVEN SISTERS ROAD CLOSURE TIMINGS
FRIDAY 05 JULY	21:00 – 00:00	22:00 – 23:30
SATURDAY 06 JULY	21:00 – 00:00	22:00 – 23:30
SUNDAY 07 JULY	20:30 – 23:30	21:00 – 22:30
FRIDAY 12 JULY	21:00 – 00:00	22:00 – 23:30
SATURDAY 13 JULY	21:00 – 00:00	22:00 – 23:30
SUNDAY 14 JULY	20:30 – 23:30	21:00 – 22:30

The following roads will be closed at all junctions joining Seven Sisters Rd between Fonthill Road & Green Lanes covering;

Hackney - Portland Rise, Brand Close, Alexandra Grove, Queens Drive, Wilberforce Road, Finsbury Park Road, Blackstock Road, Somerfield Road, junction with Blackstock Road will be residents access only.

Islington - Rock Street, Isledon Road, Fonthill Road.

Festival Republic

LIVE NATION

Festival Republic

LIVE NATION

The following roads will be closed at all junctions joining Stroud Green Road between Seven Sisters Road and Tollington Park / Upper Tollington Park:

Islington - Wells Terrace, Morris Place and Lennox Road.

Haringey – Perth Road

LOCAL BUSINESSES

Please make alternative arrangements for deliveries outside of these road closure times.

UPDATES FOR 2024

This letter includes key information, please do refer to our website for further information or contact the resident email address for clarification.

Each year, we take into consideration suggestions raised at the debriefs post event to improve the experience of the events for both customers and local residents. We would like to highlight the following points:

- Additional fencing will be erected within the park. Therefore, access in and around the park during live show days may be different than previous years. Please see the map in the middle of the letter for more information. Access to the children's play areas, sports facilities, the café, the skate park and the tennis courts will be facilitated at all times.
- Seven Sisters Road, Finsbury Park Station and Manor House Station will be very busy during the road closure times mentioned. The exit route will take customers out of the park via the arena entrance before the show goes down. Once the show goes down the exit route will flip to the North East of the park and customers will exit out onto Seven Sisters Road. From here they will turn right for Finsbury Park Station and left for Manor House Station. Those from the local area tend to walk home. We will have ample security and barriers on the junction of Seven Sisters Road and Portland Rise, Alexandra Grove, Queens Drive, Wilberforce Road and Finsbury Park Road to prevent our customers from exiting via the side streets. Local access will be facilitated.
- The internal park route from Stroud Green Road to Oxford Road Gate will be closed for a period of time during the Wireless weekend. A diversion route will be in place for local park users and access will be facilitated. Festival Republic staff will be present to ensure access is permitted for those who require it.
- Finsbury Park Station's exit route will be via City North from 18:00 each night during live shows.
- We will continue to build on our crowd management measures outside Finsbury Park Gate to ensure ease of entry into Finsbury Park, for both the local community and event customers. This will involve a combination of security guards and barriers.
- For a number of years, we have worked with Uber to minimise the disruption taxi pick-ups have on local residents at the end of each night. Drivers have a designated pick-up location on Osbourne Road. This year we will be working with Bolt too. If you live on Alexandra Grove, Finsbury Park Road, Wilberforce Road, Queens Drive or Portland Rise or in the streets between Monsell Road and Seven Sisters Road and wish to book an Uber or private hire taxi on show days then please be aware that you will have to book it to a nearby location between 20:00 and 00:00 on our live show days. This measure is an effective way to minimize traffic, anti-social behavior and noise issues in and around the local area.
- In conjunction with our partners including the Metropolitan Police, in order to constantly review the security situation, we encourage the public to report any suspicious activity to the Anti-Terrorism Hotline on 0800 789 321 or 999 in an emergency.

HOW THE EVENTS AFFECT PUBLIC TRANSPORT?

The road closures listed above will have an effect on the buses as there will be diversions in place. Finsbury Park and Manor House stations will be heavily congested from 22:00 on Friday 05, Saturday 06, Friday 12 and Saturday 13 of July as the large number of the customers attending the concert will use these stations.

On Sunday 07 July and Sunday 14 July, the shows finish earlier so these stations will be heavily congested from 21:00. For further information on any affected routes and services please check the TFL website.

Please note that heavy queues are expected at Finsbury Park Station.

WHAT MEASURES ARE BEING TAKEN TO STOP PEOPLE PARKING IN THE RESIDENTIAL AREAS SURROUNDING THE PARK?

Concert visitors have been advised that there is no parking in the area around Finsbury Park and they should plan their route using public transport. Cones and signage will be positioned at the entry roads to surrounding residential areas to reinforce the restrictions on concert traffic parking. CPZ match/event day parking controls will operate as necessary. A soft closure will be implemented in both Hackney and Islington for resident access only.

IMPACTS ON THE PARK

The build for the event starts on Wednesday 26 June at 07:00 and we will be clear of the park by 20:00 on Friday 19 July. We appreciate that it's not just the events themselves that have an impact on the park and the local community. So, we have arranged our build and breakdown periods to try and cause minimum disruption to regular users of the park; details of the routes through the park are displayed on the attached map. We have worked year round with Haringey Council on tree protection throughout our use of the park and we put down ground protection in areas used by heavy vehicles. Please see the center pages of this letter for a map of the facilities open during the events and routes in and around the park.

LOCAL SCHOOLS, PUBLIC NUISANCE & TICKET HOLDERS LEAVING FINSBURY PARK

The majority of event visitors will use Finsbury Gate to get access to the events. However, Stroud Green Gate and Manor House Gate will also be used. Oxford Rd and Endymion Rd will not be used as a primary end-of-night exit route (although could be used as an emergency exit route) with the majority of the audience remaining inside the park until they reach Finsbury Park Gate or Stroud Green Road Gate. Accessible customers will be permitted to exit via Oxford Road Gate to aid their journey to Finsbury Park Station. For ticket holders requiring services from Manor House Station, they will exit the park onto Seven Sisters Road and join the queue into the Station from there. We are in regular contact with Stroud Green Primary School to discuss our plans and how we can minimize any impact on them.

WASTE

All three councils have been consulted on external waste management in the planning phase of the events and an external waste management plan has been agreed. Haringey Waste teams will clean both Haringey and Islington's local streets while Hackney will be paid to undertake additional event cleaning within their borough. Over the years, some new roads have been added to the routes to ensure nothing is missed. Teams from Hackney and Haringey will clean Seven Sisters Rd at the end of the event days and stewards will be in place to manage people exiting Finsbury Park. Please let us know via the hotline or email if you have any issues with waste in your area.

POLICE

A police operation will be taking place in and around Finsbury Park focused on crime prevention in the local area during the event days. The MPS have worked closely with the organisers, local authorities and residents in the run up to the event. During the events, officers will be visible to respond to any incident within the area. The operation uses a mixture of officers from the local area and some from further away. However, the event doesn't take away officers from their daily duties. There is a small chance the police may be required to deploy a helicopter in the vicinity but this will be kept to a minimum and only used if necessary.

FEEDBACK

We welcome feedback on your experience of these events as it helps us to improve each day and plan for future events. If you have feedback or an enquiry regarding your experience that you wish to share with us, please visit the following websites for each event:

www.festivalrepublic.com/finsbury-park-residents-information/

If you have any questions or concerns leading up to or during the event, please don't hesitate to contact me on FinsburyPark.residents@festivalrepublic.com

Yours sincerely,

Melvin Benn
Festival Director, Festival Republic

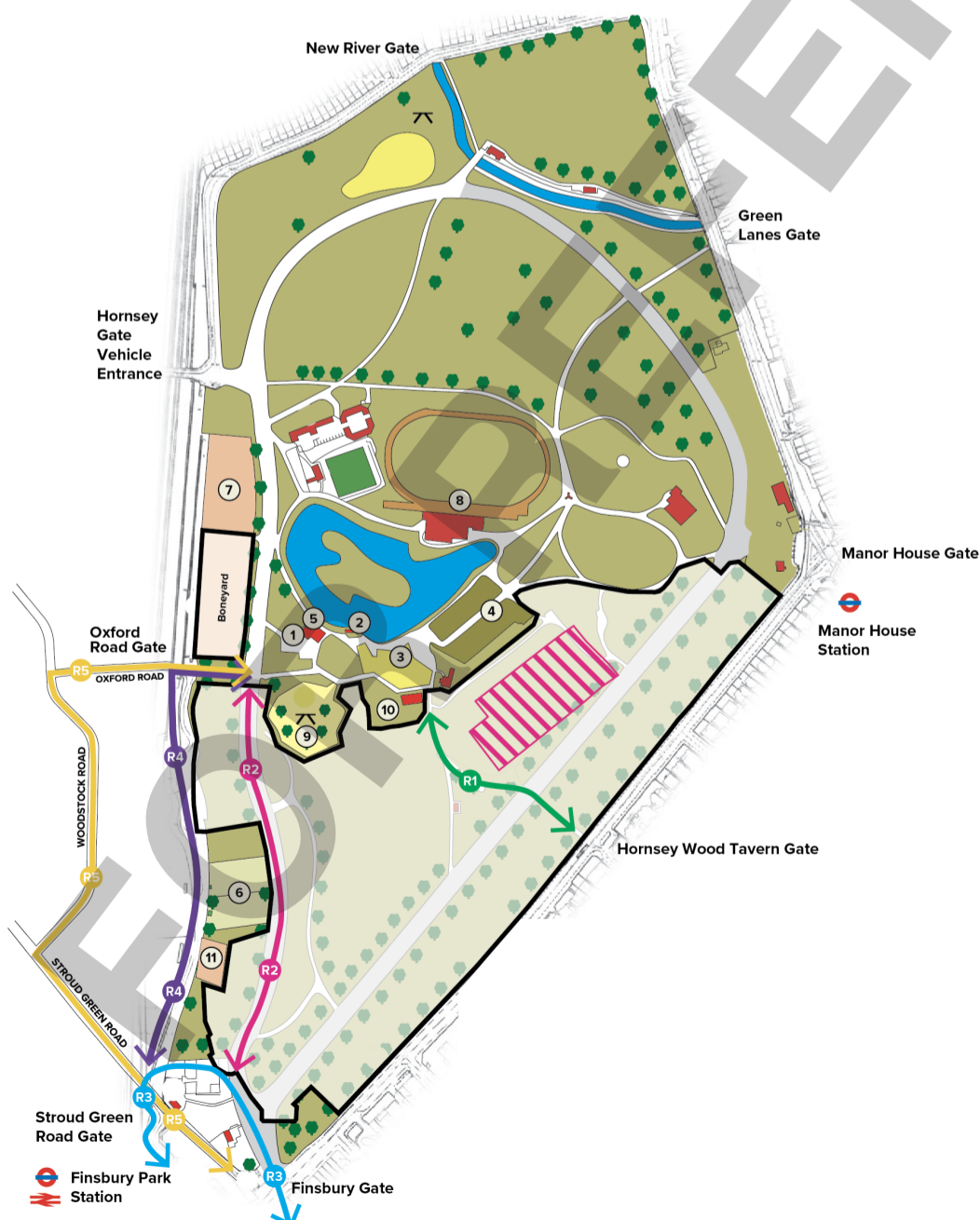

- ① FINSBURY PARK CAFE*
- ② BOATING LAKE*
- ③ PLAY+PICNIC AREA*
- ④ FLOWER GARDEN*
- ⑤ TOILETS*
- ⑥ TENNIS COURTS*
You can gain access via R4 as normal, please speak to the stewards at the gates upon arrival.
- ⑦ BALL GAMES AREA*
- ⑧ ATHLETICS TRACK*
- ⑨ RICHARD HOPE PLAY AREA*
- ⑩ OVER 8S PLAY AREA*
- ⑪ SKATEPARK*
You can gain access via R4 as normal, please speak to the stewards at the gates upon arrival.

- SITE PERIMETER
- ▨ AVAILABLE UNTIL 28 JUNE
- * AVAILABLE THROUGHOUT

DATE	WHEN	R1	R2	R3	R4	R5	NOTES
WEDS 3 JULY	BUILD	UNTIL 20:00	UNTIL 20:00				
THURS 4 JULY	BUILD						
FRI 5 JULY	THE WOLFE TONES						
SAT 6 JULY	MICHAEL BIBI						
SUN 7 JULY	HOZIER						
MON 8 JULY	BUILD	FROM 20:00	FROM 20:00				
TUES 9 JULY	COMMUNITY EVENTS		UNTIL 14:00				CLOSURE DUE TO HARINGEY COUNCIL COMMUNITY EVENT
WEDS 10 JULY	COMMUNITY EVENTS	UNTIL 20:00					CLOSURE DUE TO HARINGEY COUNCIL COMMUNITY EVENT
THURS 11 JULY	BUILD						
FRI 12 JULY	WIRELESS				14:00 - 22:30		DIVERSION IN PLACE DURING THESE TIMES
SAT 13 JULY	WIRELESS				14:00 - 22:30		DIVERSION IN PLACE DURING THESE TIMES
SUN 14 JULY	WIRELESS				14:00 - 22:30		DIVERSION IN PLACE DURING THESE TIMES
MON 15 JULY	BREAK	FROM 20:00	FROM 20:00				
TUES 16 JULY	BREAK		FROM 08:00				

- PARK ROUTES OPEN AS USUAL FROM WEDS 17 JULY
- PLEASE BE AWARE DECONSTRUCTION WILL BE TAKING PLACE UNTIL FRI 19 JULY
- WILL BE CLOSED TEMPORARILY TO ASSIST WITH EGRESS EACH NIGHT

Construction activities are being carried out on this site. Please stay on designated routes.

For the safety & security CCTV is in use at these premises.
For further information please email FinsburyPark.residents@festivalrepublic.com or on show days please call 020 8080 1459

